

MODEL 72A04-01

PROXIMITY SWITCH

All-Metal Sensing, Dual Sourcing or Sinking Outputs

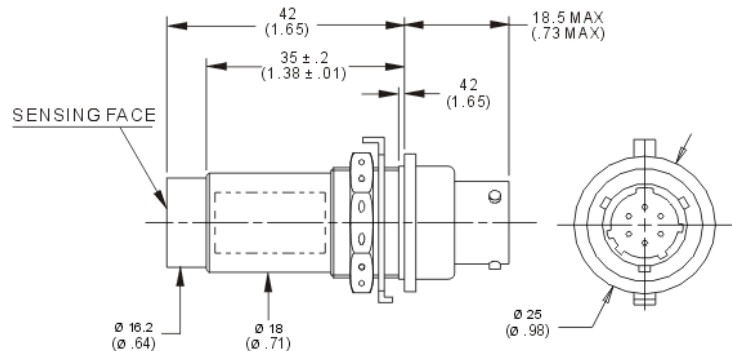

PIN	FUNCTION
A	+28 V
B	OUTPUT 1 (+)
C	OUTPUT 1 (-)
D	COMMON
E	OUTPUT 2 (+)
F	OUTPUT 2 (-)

DIMENSIONS IN MILLIMETERS
(Dimensions in inches)

Electrical Characteristics

Type: Integral Electronics, One-Piece Switch
 Output Configuration: Dual Transistor Switch to Common or Input Power
 Output Load: 500 mA Resistive (total)
 Input Voltage: 15 to 30 Vdc per MIL-STD-704C
 Input Current: 8 mA
 Guaranteed Actuation: 0.138" from Sensing Face (with Standard Target)
 Guaranteed Deactuation: 0.200" from Sensing Face (with Standard Target)

Environmental Characteristics

Environmentally sealed and qualified;
 Operating Temperature: -55 to 85 °C

Programs

Airbus A320

Additional Information

For more detailed specifications and applications information, contact:
 ELDEC France, 18, Rue du 35ieme Regiment d'Aviation, 69500 BRON - FRANCE
 Phone: (33) 478.26.10.10 • Fax: (33) 472.37.72.30
 or ELDEC Corporation, P.O. Box 97027, Lynnwood, Washington U.S.A. 98046-9727
 Phone: (425) 743-1313 • Fax: (425) 743-8234
 www.eldec.com
 Specifications subject to change without notice.
 Copyright © Nov 1999 ELDEC Corporation

Physical Characteristics

Size: As shown
 Weight: 40 grams (not including connector mating half)
 Connector: FDBA.53H10.6.PNK (MS3113H10A-6PN)
 Mounting: Threaded Barrel (as shown)
 Construction: Aluminum Barrel

Applications

Landing Gear/Undercarriage, Doors

Note:

The 72A04-01 can detect all metals including aluminum although gap variation exists depending on the target material sensed.

CRANE

ELDEC CORPORATION
 A CRANE CO. COMPANY